

APPROX. WEIGHT  
(LBS)  
99

ECO No	DESCRIPTION	REV BY	DATE
M12085	REPLACE CAPPANEL W/CAP-527SW, REPLACE CMP W/CMB-005	MN	11/08/19

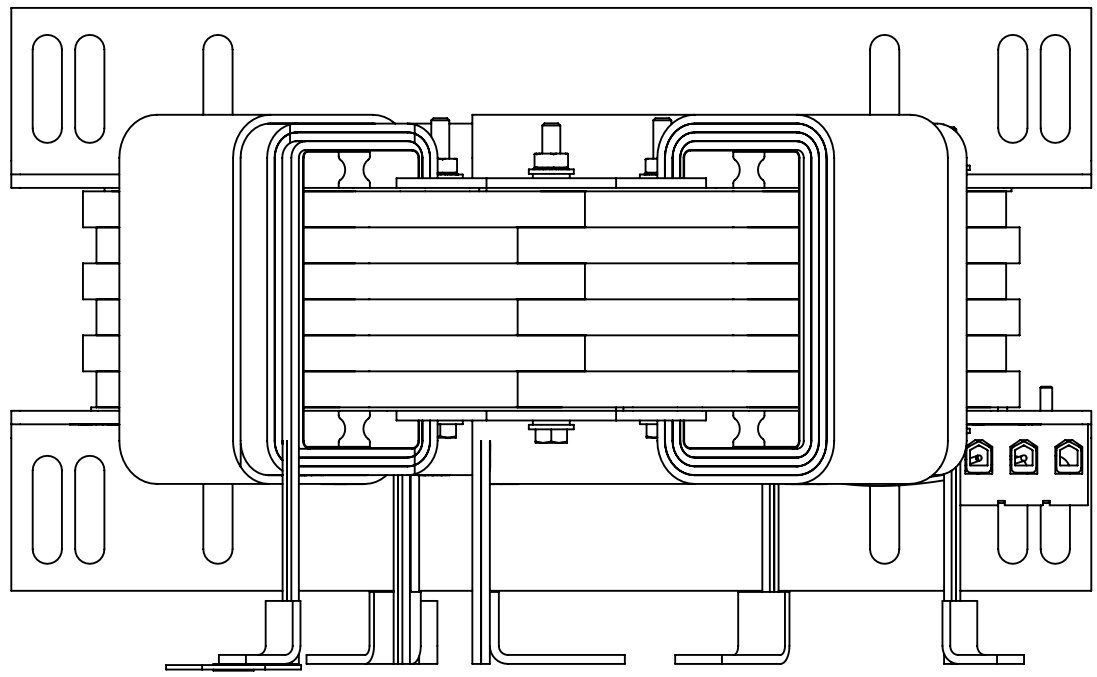

TOP VIEW

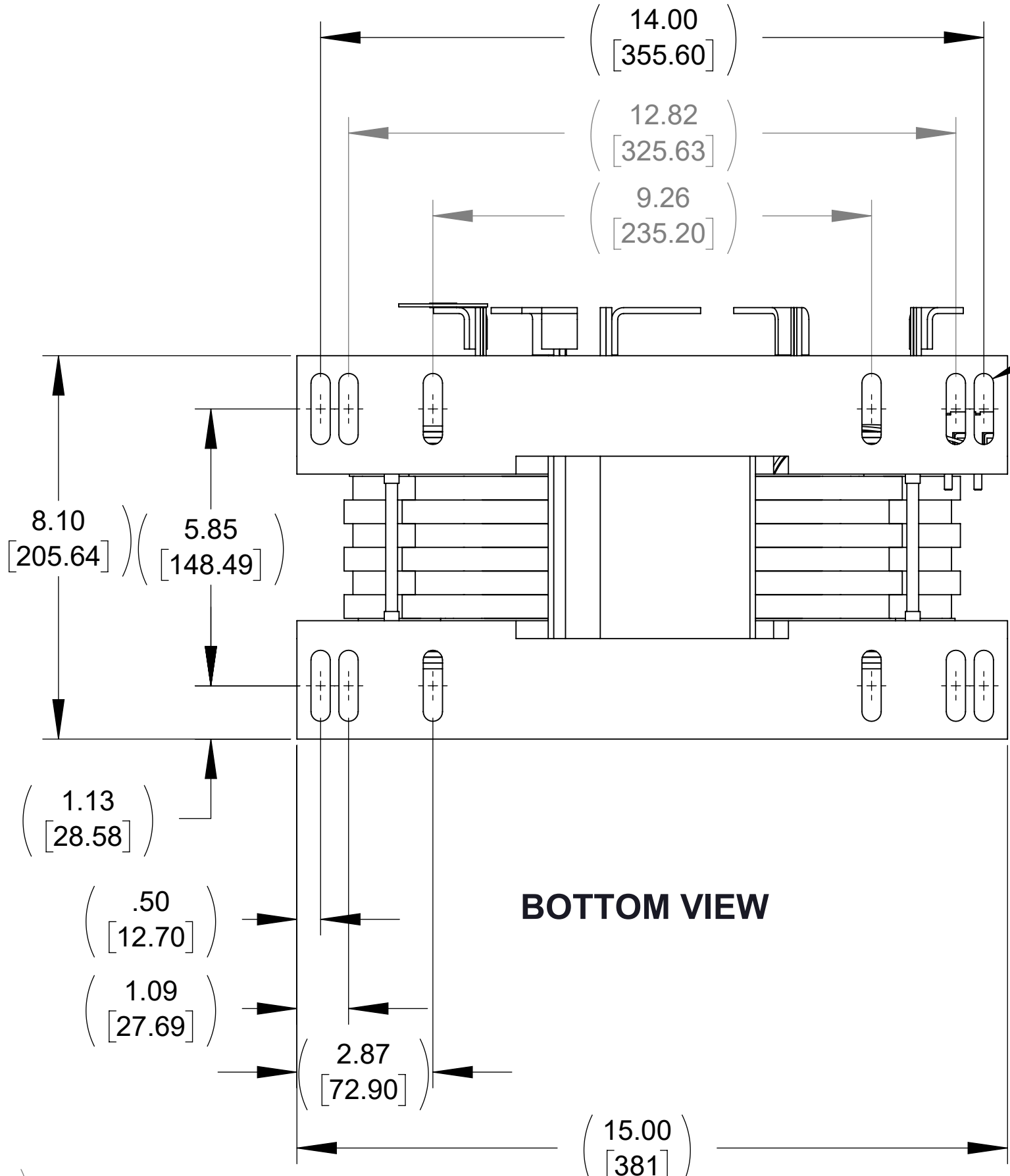

BOTTOM VIEW

(.41 [10.32] X 1.50 [38.10])  
SLOT, 12 PLACES

SEE NOTE 1

SEE NOTE 2

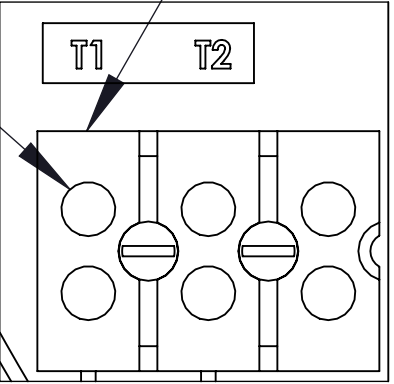

DETAIL C  
CUSTOMER CONNECTION  
DETAIL VIEW (THERMAL)

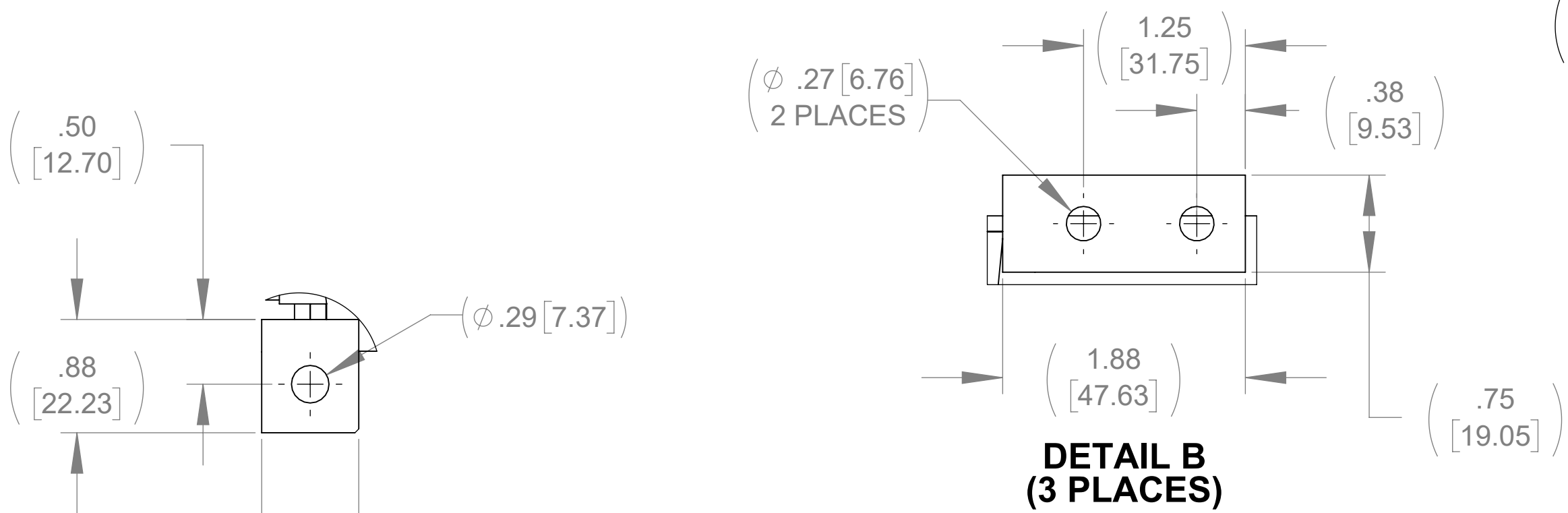
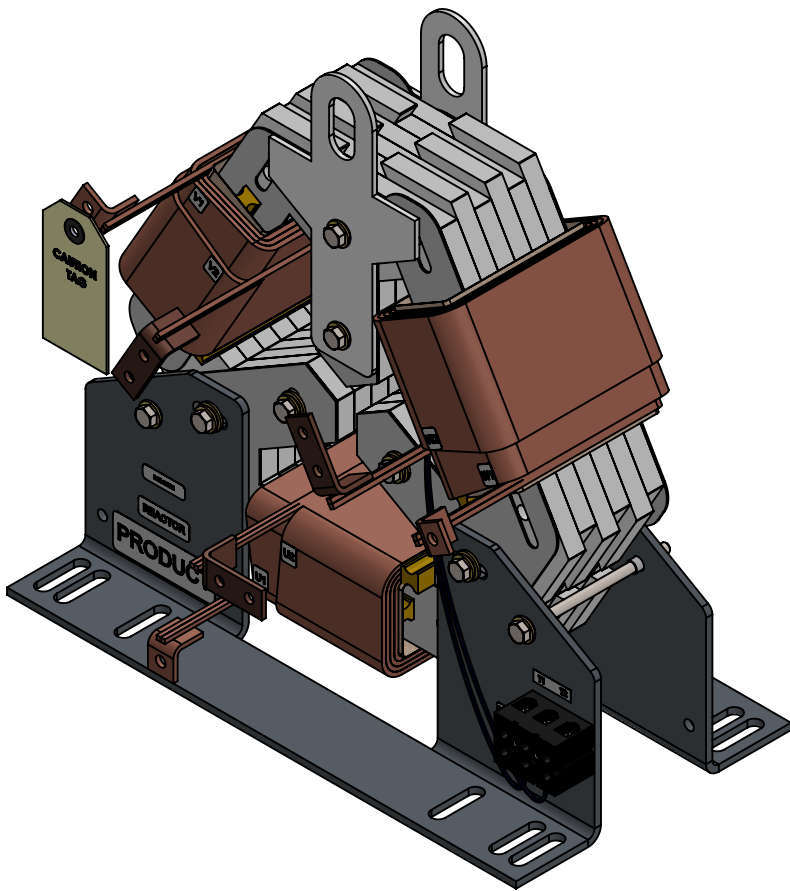

DETAIL A  
(3 PLACES)

DETAIL B  
(3 PLACES)

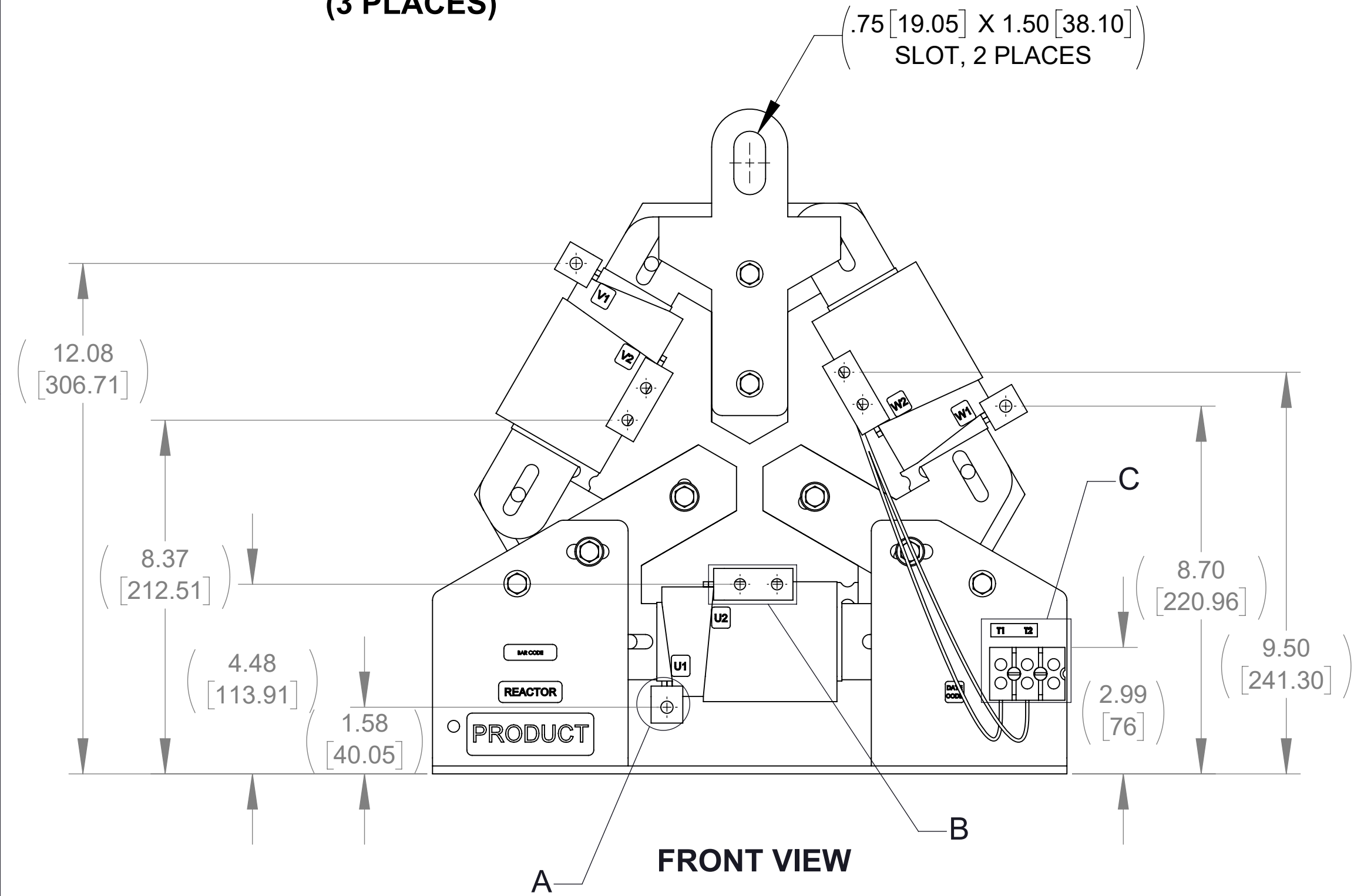

FRONT VIEW

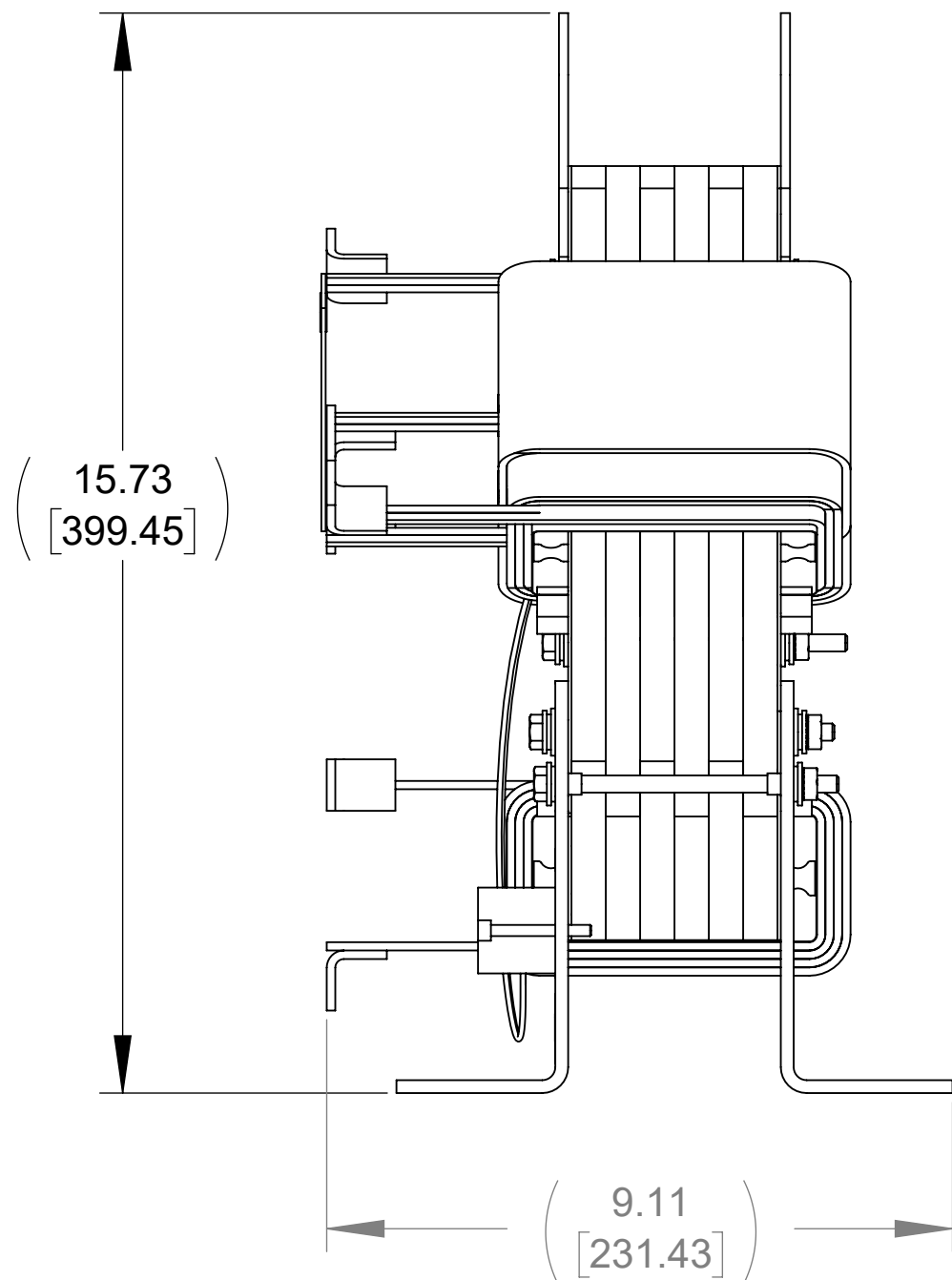

SIDE VIEW

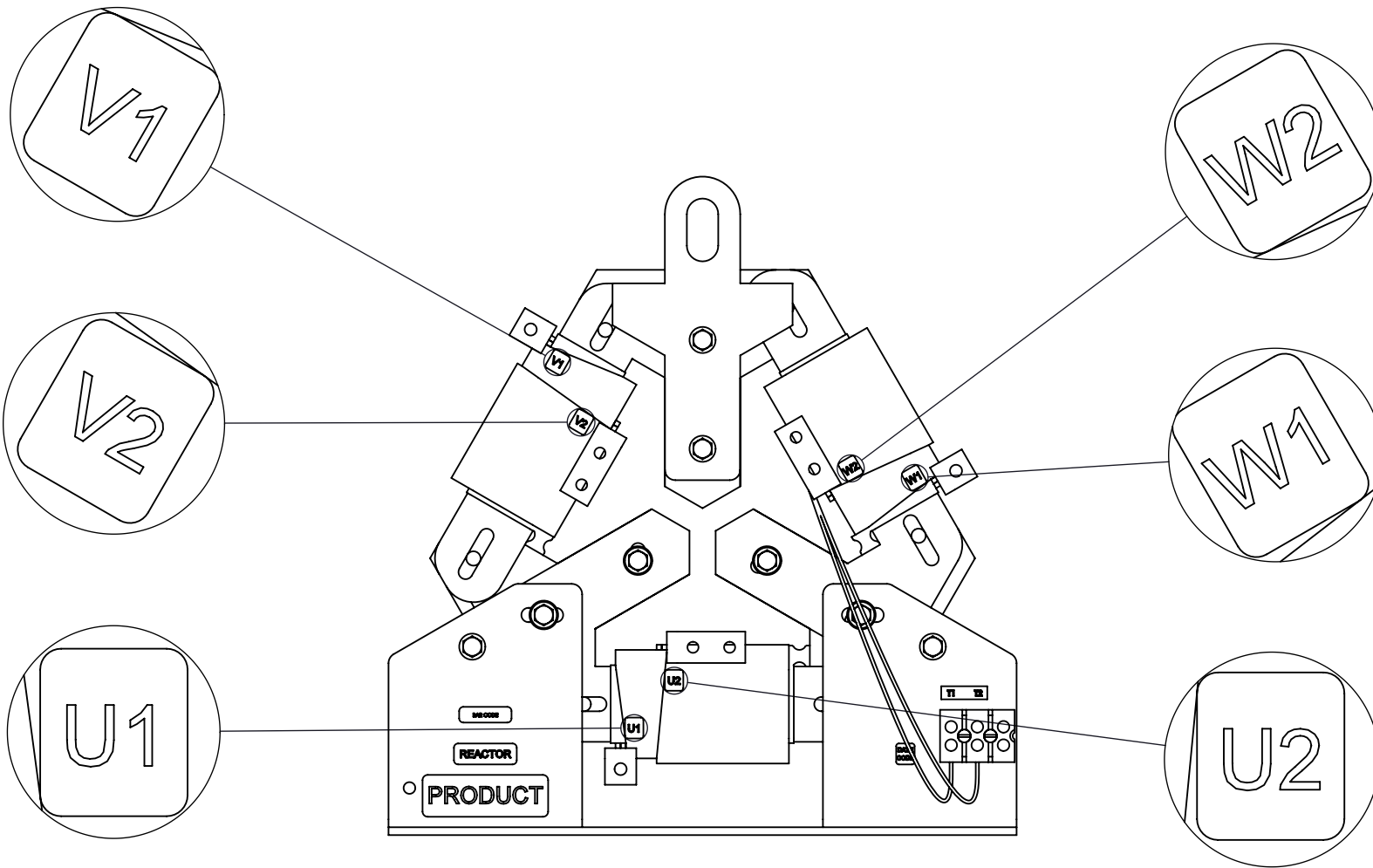

CUSTOMER CONNECTION  
DETAIL VIEW

NOTES:

1. TERMINAL WIRE RANGE: 4-18 AWG.
2. TERMINAL SCREW TIGHTENING TORQUE: 16 IN.LBS.
3. REFER TO USER MANUAL FOR COMPLETE INSTALLATION INSTRUCTIONS.
4. FILTER INCLUDES: CAP-527SW(QTY. 1) AND CMB-005(QTY. 1).

THE COMPONENT, PART OR ASSEMBLY DESCRIBED IN THIS DOCUMENT MUST COMPLY WITH THE EU(EUROPEAN UNION) DIRECTIVE RoHS2		MATERIAL		CONFIDENTIAL AND PROPRIETARY INFORMATION THIS DOCUMENT CONTAINS CONFIDENTIAL AND PROPRIETARY INFORMATION OF MTE CORPORATION AND MAY NOT BE USED, COPIED OR DISCLOSED TO OTHERS EXCEPT WITH THE AUTHORIZED WRITTEN PERMISSION OF MTE CORPORATION		
CONTAINS <0.1% OF ANY SVHC BY WEIGHT PER REACH REGULATION				DESCRIPTION		
UNLESS OTHERWISE SPECIFIED DIMENSIONS ARE IN INCHES [MM] TOLERANCES ARE:  ANGLES: ± 1 °  1 PLACE .X: ± .1 [2.5]  2 PLACE .XX: ± .03 [0.76]  3 PLACE .XXX: ± .010 [0.254]		<b>MTE</b> POWER QUALITY. SOLVED.  N83 W13330 Leon Road Menomonee Falls, WI 53051 USA 800.455-4683 262.253.8200		SINEWAVE NEXUS FILTER 45A 600V 60Hz OPEN PANEL		
DRAWN MN		DATE 06/20/19		SIZE D		
CHECKED MN		DATE 11/08/19		DWG No. CD SWNM0045E		
APPROVED RH		DATE 11/14/19		REV 01		
SCALE 3:8				SHEET 1 OF 1		